

1995 UPA NORTHWEST REGIONAL CHAMPIONSHIPS



LACEY, WASHINGTON

1995 Northwest Regional Championships

Welcome to Lacey! You should find all the info you'll need in here.
Have a great weekend. If you have any questions, head to Frisbee
Central. Play hard and may the best team win.

Here are the pools. . .

Women

Pool A

Women on the Verge
The Farm
Priscilla Queen of the Disc
Wasabi
Snatch

Pool B

Schwa
Townies
Eugene
Sol Sistas
See Jane

Pool C

Phat City
Salt Lake Virus
Tomatoes
Stumpie Joe

Men

Pool A

Double Happiness
Spud Bozs
Black Mountain
Wonka Chocolates
Coho

Pool B

Rhino Slam
JOE
Furious George
Ketchum
Cadillacs

Pool C

Sockeye
Cutthroat
Jaded
Slap Happy
Special Boys

Pool D

El Camino
DaMento
Kodiak
I Love Lucifer
Eugene

Women's Masters

Old Hags
Out Laws

Men's Masters

Us
Them
Seattle

Women's Pool Play

(Saturday)

Pools A & B (games to 11)

BYE

8:00-9:30	1 vs 3	4 vs 5	2
9:45-11:15	1 vs 5	2 vs 4	3
11:30-1:00	2 vs 5	3 vs 4	1
1:15-2:45	1 vs 4	2 vs 3	5
3:00-4:30	1 vs 2	3 vs 5	4

Pool C (games to 13)

9:00-10:45	1 vs 3	2 vs 4
11:00-12:45	1 vs 2	3 vs 4
1:00-2:45	1 vs 4	2 vs 3

5:00-7:00 **QUARTERS**

(Sunday info to come)

Men's Pool Play

(Saturday)

BYE

8:00	2 vs 4	3 vs 5	1
10:00	2 vs 3	1 vs 5	4
12:00	1 vs 2	3 vs 4	5
2:00	1 vs 4	2 vs 5	3
4:00	1 vs 3	4 vs 5	2

(Sunday)

8:00	1 vs 7	2 vs 8	3 vs 5	4 vs 6
10:00	1 vs 4	2 vs 3	5 vs 8	6 vs 7
12:00	3 vs 6	4 vs 5	(1 & 2 bye)	
2:00	1 vs 2	3 vs 4		
4:00	2 vs 3			

Women's Masters

Men's Masters info to come.

11:00

1:00

3:00

Martin
way

North Thurston Site

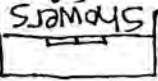
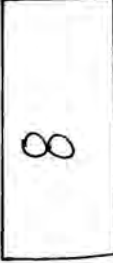
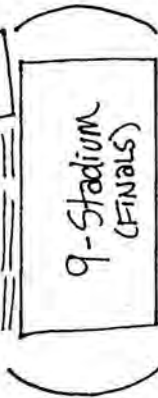
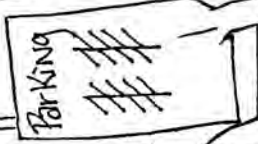
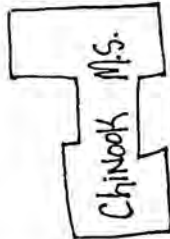
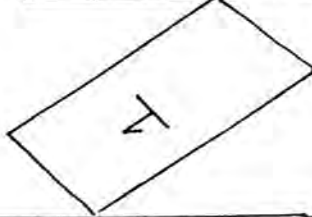
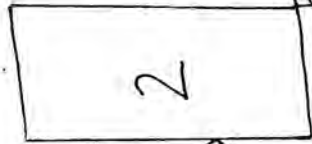

5-8 pm (sat + sun)

Parking

North
Thurston
H.S.

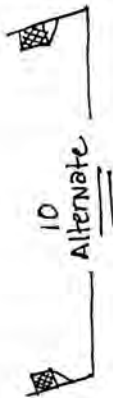

College St

College St (1st Ave)

River Ridge Site

Directions

FROM N. Thurston:
 Follow College St. to
 Martin Way - Go left.
 Get on I-5 North.
 Take The Marvin Rd.
 exit. Go right. TO
 Martin Way.
 Go left onto
 Martin
 Way. Go
 to the next
 stoplight. Turn
 Right. School
 is on the
 left.

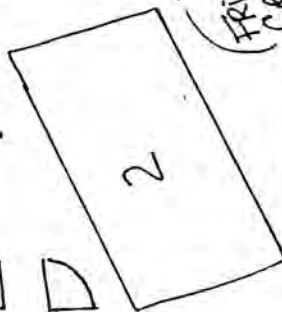
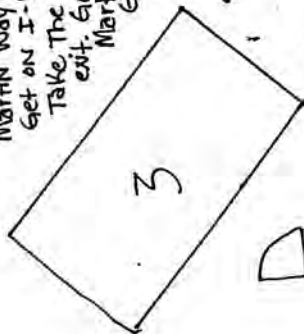
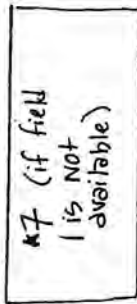
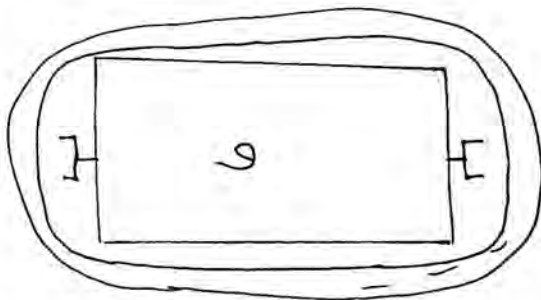

Frisbee
Central

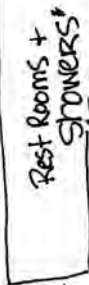

15-8pm
Sat.

Parking

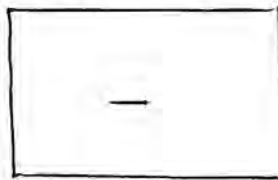
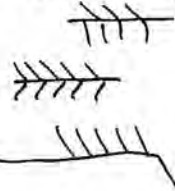

Marvin Way

Komachin Middle School N↑

From North Thurston:

- Turn out of the Parking lot onto 6th Ave/College St.
- (Go Right)
- Follow around to Right (turns back into College St.)
- Stay ON College St. ~ 2 miles
- School is ON the left.

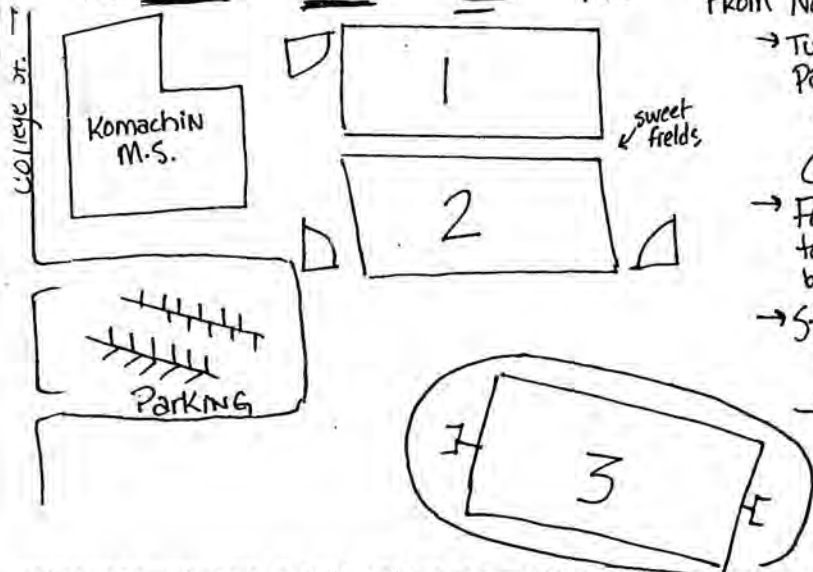

Nisqually Middle School ← N

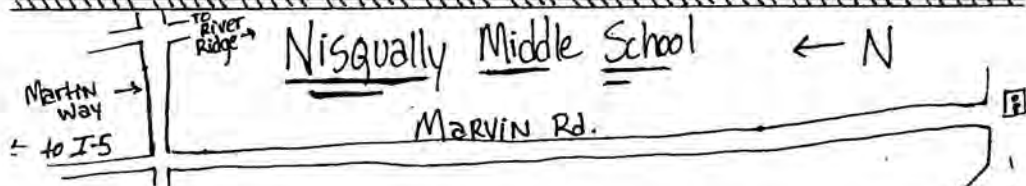

From River Ridge:

- Go back out to Martin Way
- Turn left
- Go to Marvin Rd. (~ 2 blocks)
- Turn Left
- Go to Steilacoom (8 blocks)
- Turn Right
- School is immediately to the right.

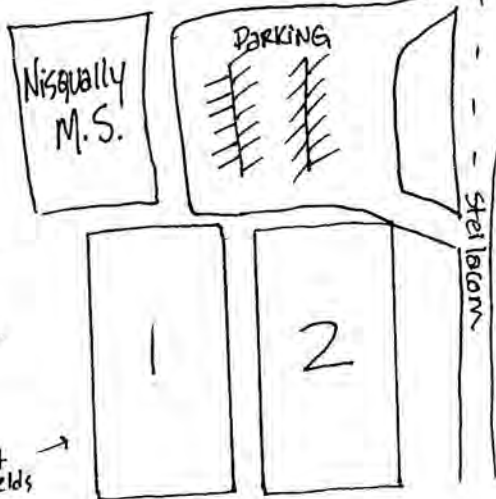

Directions Page

To Lacey Heading South on I-5, drive right on past Tacoma and take the Sleater-Kinney Road exit (#109) and turn right off the exit onto Martin Way. Turn right at the first light onto College St., then veer to the left onto 6th. The High School will be right there. It is called Thurston H.S. and Chinook Middle School.

Heading North on I-5, drive right on past Olympia and take Exit 108. Make sure to take the off-ramp that puts you on Sleater-Kinney going **North** (it's a loop-de-loop). Go past North Thurston H.S. and turn right onto 6th Ave. Park on the other side of the Stadium at Chinook Middle School.

To Women's Fields (River Ridge High School)

8929 Martin Way E.

From I-5, take the Hawks Prairie exit. Then, get onto Marvin Rd. heading South. If you're coming from the North, turn left onto Marvin Rd. If you're coming from the South, turn right onto Marvin Rd. The first major intersection is Martin Way. Go left here. At the next stop light, you will see the entrance to River Ridge High School. And there you are.

To Nisqually from River Ridge

Turn left onto Martin Way.

After about two blocks, turn left onto Marvin Rd.

Cruise about eight blocks, then turn right onto Steilacoom.

The school is on the right.

To Kamachin from North Thurston

Turn out of parking lot by taking a right onto 6th.

Follow the road around to the right and it turns back to College St.

Stay on College St. for about 2 miles.

The school is on the left.

Entry Fee

If you haven't already, please write one check to the UPA for your team fee: \$25

And also, the tournament fee (to be made out to Rene Alexander):
Open Mens and Womens = \$175 Masters = \$150

Showers

You'll find one set on the North Thurston campus next to the tennis courts and they will be open from 5pm-8pm. There are also showers at the River Ridge complex.

Party!

Olympia Eagles
805 E. 4th Ave.

From North Thurston, go right onto Martin Way
From River Ridge, go left onto Martin Way

Follow Martin Way towards Olympia. It goes all the way into town and changes into State St. Turn left onto East Bay Dr., which turns into Plum. The Olympia Eagles is on the corner of 5th and Plum (East Bay).